

[Home](#) ■ [Products](#) ■ [Storm & Sewer Equipment](#) ■ [Combined Sewage Screens](#) ■
[HUBER Storm Screen ROTAMAT® RoK1 for stormwater discharges](#)

HUBER Storm Screen ROTAMAT® RoK1 for stormwater discharges



Automatically cleaned screen for solids retention in stormwater tanks and overflows

- Efficient solids separation
- Continuous automatic screen cleaning
- Defined solids removal
- For discharges with limited upstream head possibilities
- Sturdy, low-maintenance stainless steel design

The HUBER ROTAMAT® RoK1 storm screen belongs to a group of fine screens designed for high flow rates at an extremely low hydraulic resistance. Two-dimensional screening guarantees a very high solids retention combined with automatic, gentle cleaning of the perforated plate.

During and after storm events large amounts of debris are discharged to streams, rivers and lakes through storm water overflows of combined and sanitary sewer systems. Particularly endangered receiving water courses and nature preservation areas require more extensive measures concerning the treatment of stormwater. The ROTAMAT® RoK 1 screen is the ideal solution for this task, whether for new structures or refurbishment.

RoK 1 screens are horizontally installed directly behind the downstream side of overflow weirs. A screw flight is mounted on a half cylinder of perforated plate. As the stormwater flows through the horizontal perforated half-pipe of the screen trough the solids are

retained. A screw, with a brush attached on its flights, rotates within the semi-circular screen trough. It cleans the screen and pushes the screenings gently towards the end of the trough. At the end of the trough, the screenings are returned into the sewer and carried to the wastewater treatment plant. Alternatively, the screenings are removed from the plant with a pump for further disposal. During storm conditions the screen is automatically started and then works fully automatically.

Benefits

The screen is installed behind the weir overflow. This design results in the following favourable benefits:

- Optimal solids retention by means of twodimensional screening (perforated plate)
- Low hydraulic resistance due to installation behind the overflow at weir height
- The perfect solution for discharges with limited upstream head possibilities
- Defined screenings discharge
- Problem-free retrofitting into existing structures
- Possibility of completely submerging the screen

Downloads

 [Brochure: HUBER Storm Screen ROTAMAT® RoK1 for stormwater discharges](#) [pdf, 306 KB]

Case Studies

- [HUBER Technology's innovative, risk free, proven & versatile CSO / stormwater screening solutions](#)
- [Storm Screening Case Study at Crankley Point STW](#)
- [Optimised stormwater overflow tank functions at Kappern/Austria](#)
- [RoK1 Storm Screen Excels at Wigan, UK](#)
- [Your risk free supplier for CSO/Stormwater screening applications](#)

Design Sketch

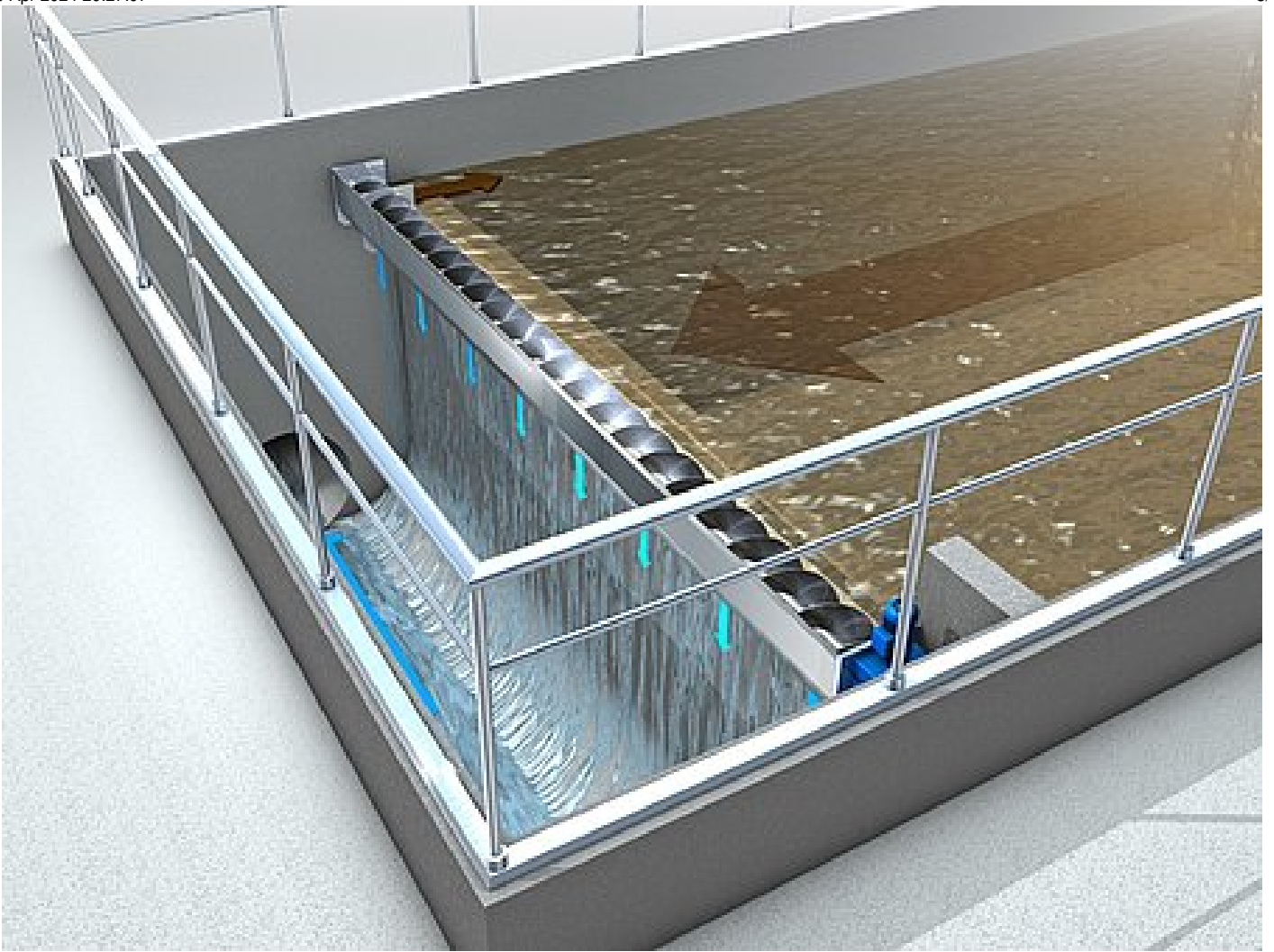

Media

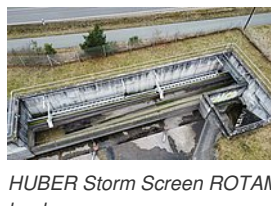

HUBER Storm Screen ROTAMAT® RoK1 TS with a cross conveyor for high solids loads



HUBER Storm Screen ROTAMAT® RoK1 TS for defined discharge of screenings

More products of this group: Combined Sewage Screens

- [HUBER Storm Screen ROTAMAT® RoK2 for stormwater discharges](#)

Huber Technology Middle East (FZE)
P.O. Box: 120137
Plot J2-08
Sharjah International Free Zone
United Arab Emirates

Tel.: +971 6 5574059
Fax: +971 6 5574069

Email: info@huberme.com
Internet: www.huberme.com

Member of the HUBER group:
www.huber.de